

SE Spa Electrics®

retro®

REPLACEMENT LED POOL LIGHT

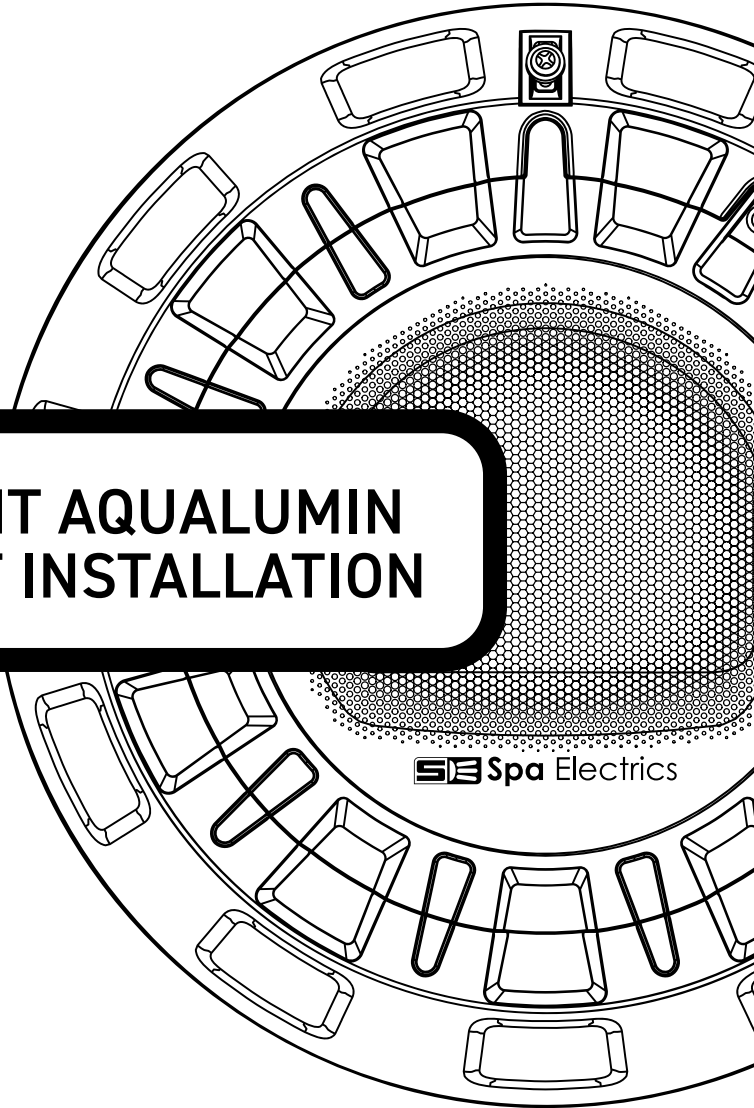

**POOL LIGHT AQUALUMIN
RETRO-FIT INSTALLATION**

SE Spa Electrics

R10A

INSTALLATION & OWNER'S MANUAL

CONTENTS

PRE-INSTALLATION CHECK 3

READ THIS FIRST 5

TOOLS REQUIRED 6

INCLUDED PARTS 7

INSTALLATION A: CONNECTION TO CABLE 8

B: ATTACH ADAPTOR PLATE 17

C: CONNECT LUMINAIRE 21

D: FIT LIGHT INTO ADAPTOR PLATE 22

POST INSTALLATION CHECK 23

WINTERIZATION 24

TROUBLESHOOTING 27

ELECTRICAL GROUNDING 28

FCC COMPLIANCE STATEMENT 28

KEY DIMENSIONS 29



NOTICE

FRESH WATER USE ONLY.
NOT INTENDED FOR OPERATION OUT OF WATER.

PRE-INSTALLATION CHECK

1 CHECK POWER SUPPLY

1A: IF THE POOL LIGHTS ARE DIRECTLY CONNECTED TO A 120V POWER SUPPLY, DO NOT CONTINUE INSTALLATION

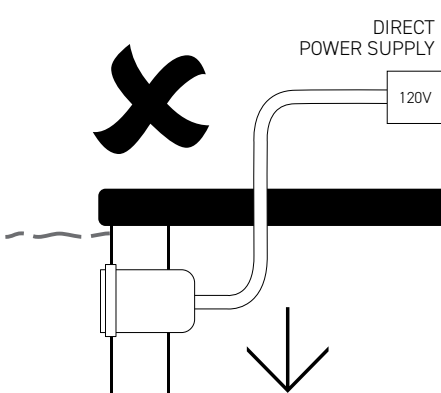

1B: A 12V AC TRANSFORMER **MUST** BE INSTALLED BETWEEN THE 120V POWER SUPPLY AND POOL LIGHT

2A: IF THE POOL LIGHTS ARE CONNECTED TO A TRANSFORMER CHECK THAT IT MEETS STEP 2 REQUIREMENTS

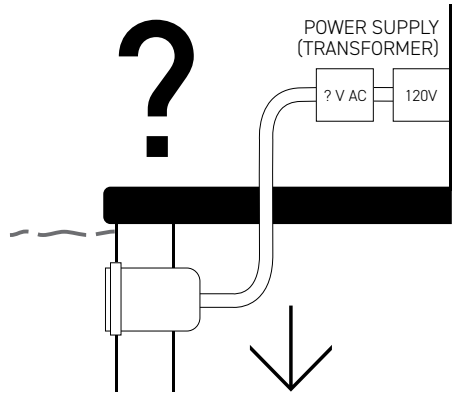

2B: IF THE TRANSFORMER DOES NOT MEET THE REQUIREMENTS, IT WILL REQUIRE REPLACEMENT

2 ADD TRANSFORMER (IF NEEDED)

EXISTING TRANSFORMER MUST BE:

- UL Listed Isolating Low Voltage power supply, evaluated for swimming pool use
- Installed as per current NEC wiring rules
- 12-14v AC output
- Minimum 50W per Retro Series Pool light
- In good working order

EXISTING TRANSFORMER MUST NOT BE:

- DC or LED Driver
- Electronic or Switch mode
- Weather damaged or in otherwise poor condition

PRE-INSTALLATION CHECK

3 CHECK PLUG CABLE THICKNESS

RETRO UNIVERSAL CAN FIT CABLES FROM 9/32" (7mm) UP TO 9/16" (14mm) DIAMETER

Max \varnothing
9/16 inch
(14mm)



4 CHECK BONDING

ENSURE BONDING CABLE IS SECURED. **DO NOT CUT** THE BONDING CABLE

DO NOT DISTURB THE BONDING CABLE WHEN WORKING WITH THE PLUG CABLE

ELECTRICAL GROUNDING



DUE TO ITS PLASTIC HOUSING DESIGN, THE RETRO UNIVERSAL LUMINAIRE DOES NOT REQUIRE GROUNDING / BONDING.

SEE ELECTRICAL GROUNDING SECTION FOR MORE INFORMATION

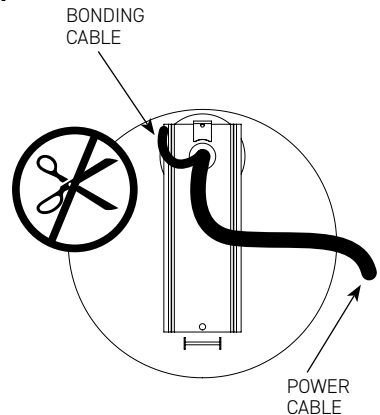

5 CHECK EXISTING MOUNTING PLATE

THE RETRO R10A LIGHT IS DESIGNED TO BE INSTALLED ON AN AQUALUMIN MOUNTING PLATE AS ILLUSTRATED WITH BOTTOM HOOK AND TOP SCREW HOLE INTACT.

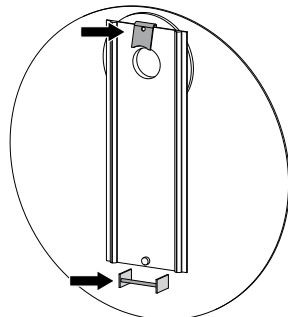

READ THIS FIRST

Congratulations on your purchase of a Spa Electrics **Retro R10A** Series Pool Light. This light has been designed in conjunction with leading pool professionals across the USA and manufactured solely in Australia.

The Retro R10A Series Pool light is designed to quickly and easily replace the existing **LOW VOLTAGE**, AquaLumin from Pentair®. Its stainless steel spring feature allows for simple installation with the existing mounting features.

For safe and proper installation, please read this manual in full before commencing installation and use only the parts (screws, plugs, sealant etc) as provided.

For operating instructions, please refer to the MULTI PLUS Operating Manual.
(Provided)

NOTE: The use of DC / Electronic (or Switch mode) power supplies is not permitted as they can cause disruptions in the lights normal operation & in some cases damage the lights internal electronic components. For more information, please contact Spa Electrics Inc.

WARNING



- The **Retro R10A** Light must be water cooled at all times. DO NOT switch the light on until installation is complete and the light is fully submerged in water.
- Ensure sufficient cable is coiled behind the light to allow for servicing (~12 to 24inch)
- Ensure only circular cable not exceeding 14mm diameter is connected to the **Retro R10A** Light. The use of Fig. 8 or non circular cable will not seal correctly & will void the product warranty.
- The **Retro R10A** LED Light does not contain any user serviceable parts, opening the light will void the product warranty.
- Pool chemicals & pH levels: Due to the corrosive nature of unbalanced pool chemicals, Spa Electrics strongly recommend that your pool water is balanced prior to installing your pool lights or any plastic or stainless steel components, and tested weekly to maintain these levels. pH levels should be maintained between 7.2- 7.6 at all times to ensure the longevity of these components.
 - Failure to do so can result in chemical damage to the light housing and pool fittings, including stainless steel components.
 - Please note: Lights or components found to have excessive chemical damage will not be covered under our manufacturer's warranty policy

TOOLS REQUIRED

- ✓ Phillips Head Screwdriver
- ✓ Small Flat Blade Screwdriver

IMPORTANT NOTES



- The use of power tools during installation is **not** recommended as these devices can cause faults and damage to light components.
- All installation steps should be carried out with manual tools only.
- The enclosed images are for illustrative purposes only. Appearances of parts and assemblies may vary from the enclosed illustrations.
- Please contact your reseller if you have any questions regarding the correct installation of this product.

WINTERIZATION



- Lights must be removed from the pool wall and cable disconnected via plug connection & stored in a safe place.
- Winterization Cover must be fitted to Plug Top.
- Unless the conduit connection is adequately sealed (i.e. via included cable gland components), the pool water level must be drained down 12" below the lowest light(s) position in the pool wall.
- All conduits should be checked for accumulated water and drained if required.
- Follow instructions in the Winterization section OR consult your local pool professional for a complete pool winterization process.

PRODUCT SUPPORT AND INFORMATION

For the most up to date installation and contact information, please visit www.spaelectrics.com

INCLUDED PARTS

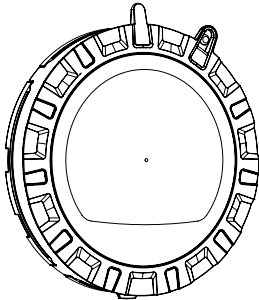

LIGHT ASSEMBLY
with RIM (P/N: R10 004)
attached

AQUALUMIN ADAPTOR (P/N: R10A 008)

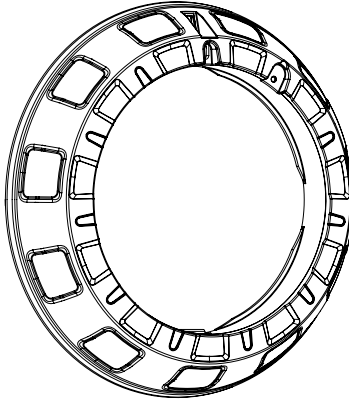

MOUNTING SCREW & WASHER

(P/N: R10A 002)

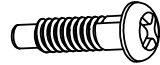

ADAPTOR
MOUNTING SCREW



ADAPTOR
MOUNTING WASHER

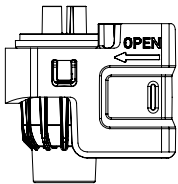

QUICK CONNECT PLUG
(PROVIDED AS
COMPONENTS SEE BELOW)



LIGHT MOUNTING
SCREW (SPARE)



ADAPTOR
MOUNTING SCREW
(SPARE)



LANOLIN

LANOLIN

Also included is a
Winterization Plug
Cap if required for
seasonal
upkeep.

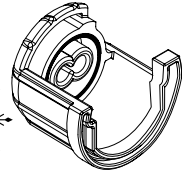

CONNECTOR PLUG COMPONENTS

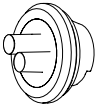

Screw Terminal
End with filling
screws attached



Strain Relief
Clip

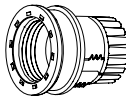

Connector
Barrel



Glands
x 3 sizes
provided



Gland
Nut

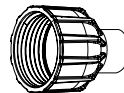

Large Gland Nut
(also supplied)

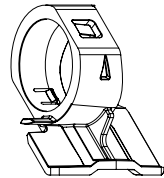

Connector
Collar

REQUIRED PART (NOT INCLUDED)



UL LISTED ISOLATING LOW VOLTAGE POWER SUPPLY, EVALUATED FOR SWIMMING POOL USE.

Installed as per current NEC wiring rules. 12-14v AC output. Minimum 50W per Retro Series Pool Light.

Spa Electrics recommends the use of its "LVX Series" safety transformers with the Retro Series lights.

A: CONNECTION TO CABLE

**STOP! WARNING
ELECTROCUTION**



CHECK POWER IS
TURNED OFF FIRST

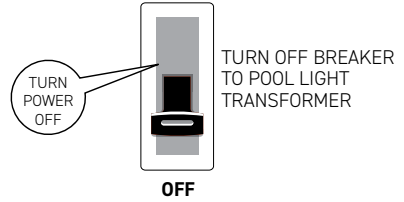

1 REMOVE EXISTING LIGHT

REMOVE EXISTING LIGHT FROM MOUNTING PLATE AND BRING TO THE SURFACE FOR CONNECTION

ENSURE YOU DON'T DISTURB THE BONDING CABLE

ALL CABLE CONNECTIONS ARE TO BE DONE AT SURFACE LEVEL AND OUT OF WATER

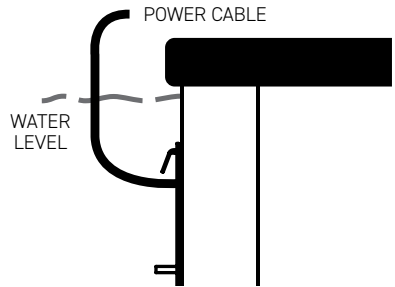

2 DISCONNECT EXISTING LIGHT

DISCONNECT LIGHT FROM POWER CABLE

CUT POWER CABLE AS CLOSE TO BACK OF EXISTING LIGHT AS POSSIBLE

ENSURE BONDING CABLE IS NOT CUT OR DISTURBED

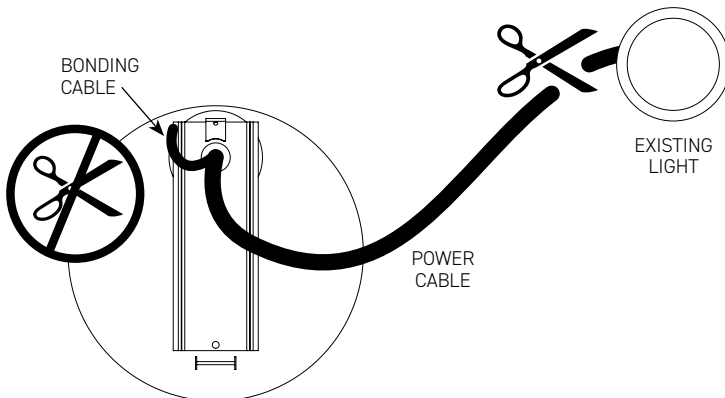

3

CABLE PREPARATION

STRIP POWER CABLE TO SPECIFIED LENGTH

NOTE



IF CABLE LENGTH ALLOWS, CUT CABLE BACK UNTIL FRESH COPPER APPEARS.

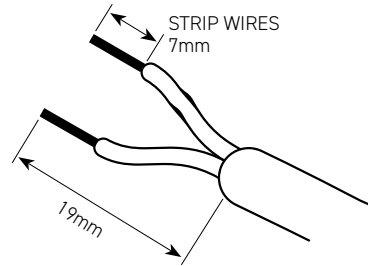

NOTE



THE EXISTING CABLE MAY INCLUDE A GROUND WIRE (GREEN), CUT THIS WIRE OFF AS THIS IS NOT REQUIRED FOR CONNECTION TO THE SPA ELECTRICS LIGHT AND DOESN'T FOLLOW THE CABLE PREPARATION STEP.

CABLE LENGTH



KEEP CABLE LENGTH AS CLOSE AS POSSIBLE TO 28" (700mm) TO ENSURE AN EASY LIGHT INSTALLATION. CABLE LENGTHS THAT ARE LONGER OR SHORTER MAY MAKE IT HARDER TO FIT THE LIGHT ASSEMBLY TO THE ADAPTOR PLATE.

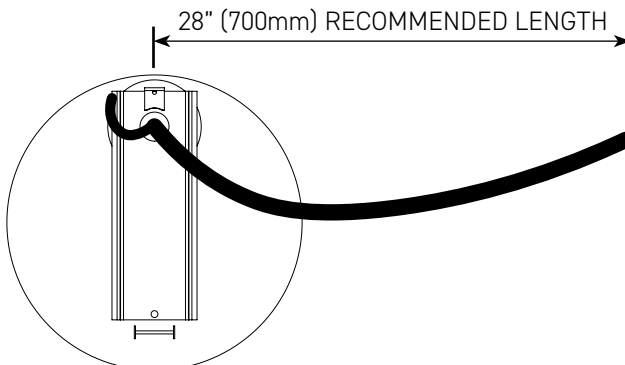

4

START ASSEMBLY OF CONNECTOR PLUG

LANOLIN USE



GENTLY WARM
LANOLIN
BEFORE USE

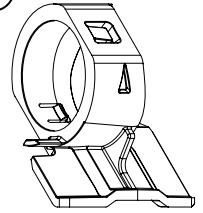
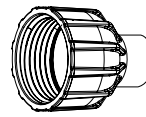
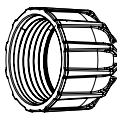
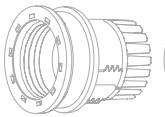
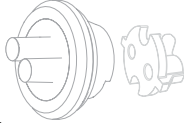

GLAND NUT

LARGE GLAND NUT

CONNECTOR COLLAR

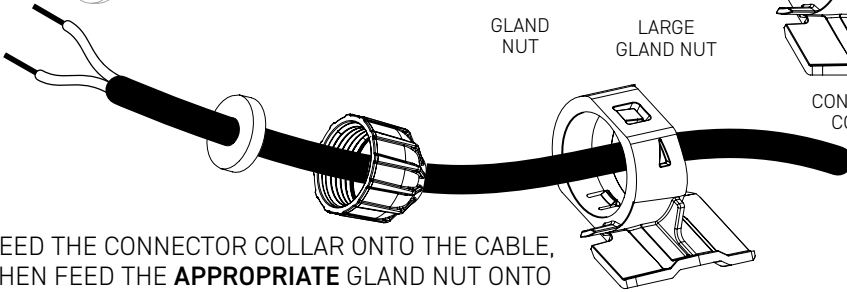

FEED THE CONNECTOR COLLAR ONTO THE CABLE, THEN FEED THE **APPROPRIATE** GLAND NUT ONTO THE CABLE

5

CHOOSE THE APPROPRIATE GLAND

SELECT THE APPROPRIATE CABLE GLAND FROM THE THREE SUPPLIED THAT SNUGLY FITS THE EXISTING POWER CABLE WITHOUT BULGING

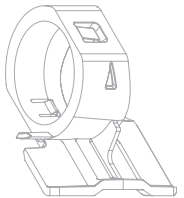
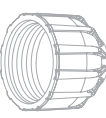
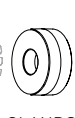
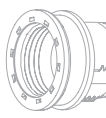

GLANDS
X 3 SIZES
PROVIDED



SMALL
GLAND
RED



MEDIUM
GLAND
BLUE



LARGE
GLAND
GREEN

THE GLAND FITMENT SHOULD BE FIRM OVER THE CABLE WITHOUT BULGING OR DEFORMING THE GLAND

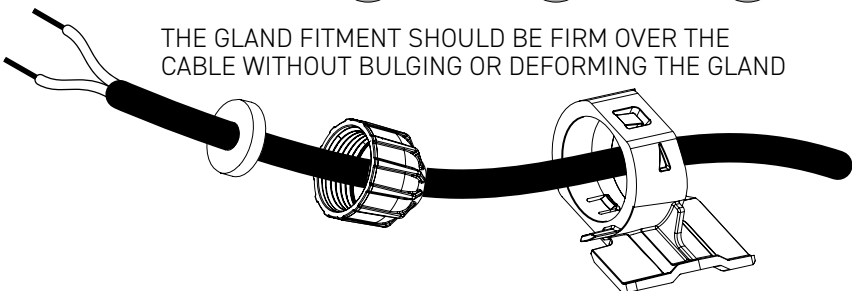

6

CONTINUE ASSEMBLY OF CONNECTOR PLUG

FEED THE CONNECTOR BARREL ONTO THE CABLE

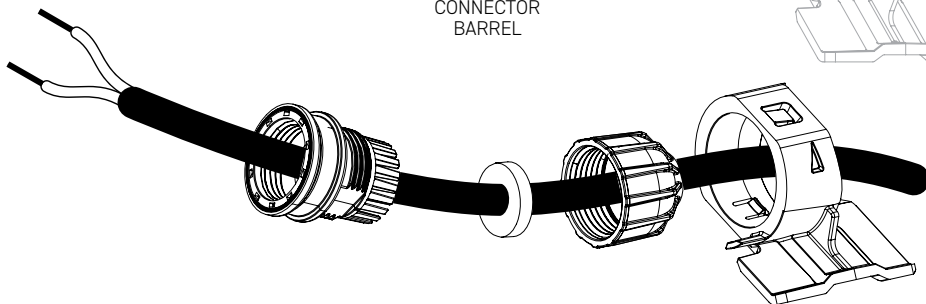
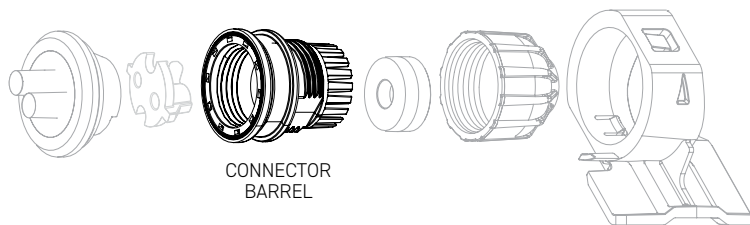

7

CHECK SCREWS ON SCREW TERMINAL END

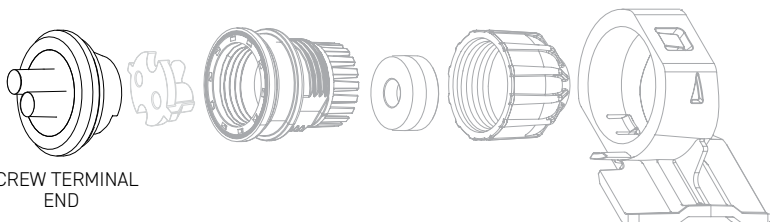

CHECK IF SCREWS ARE PRESENT IN THE TOP OF THE SCREW TERMINAL END

WITH SCREWS

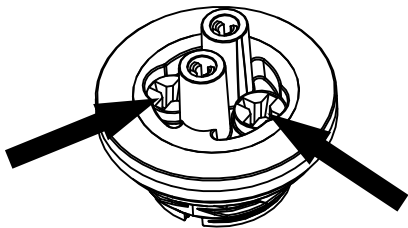

USE A MANUAL PHILLIPS HEAD SCREWDRIVER TO ENSURE THAT THE 2 SCREWS INDICATED ARE FULLY SEATED. PROCEED TO STEP 8.

WITHOUT SCREWS

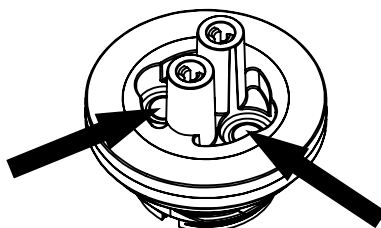

CHECK THERE ARE NO HOLES IN THE INDICATED LOCATIONS.

PROCEED TO STEP 8.

8

STRAIN RELIEF CLIP

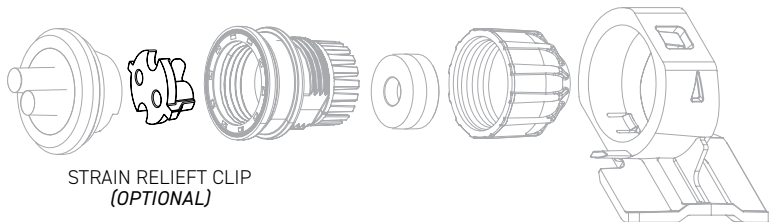

STRAIN RELIEF CLIP
(OPTIONAL)

OPTION 1: WHEN USING THE MEDIUM OR LARGE CABLE GLANDS, THE STRAIN RELIEF CLIP IS NOT REQUIRED. FOLLOW STEP 9A (IGNORE STEP 9B).

OPTION 2: THE STRAIN RELIEF CLIP MUST BE USED WHEN THE SMALL CABLE GLAND IS USED. FOLLOW STEP 9B (IGNORE STEP 9A).

STRAIN RELIEF CLIP REQUIRED



SMALL
GLAND



MEDIUM
GLAND



LARGE
GLAND

9A

CONNECT THE SCREW TERMINAL END

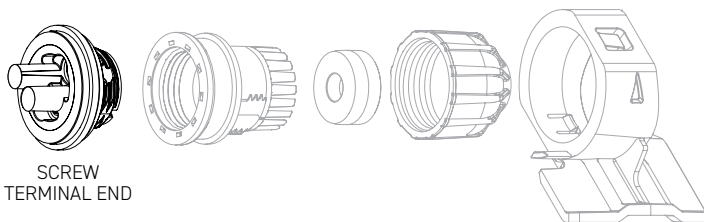

SCREW
TERMINAL END

- 1: FEED THE TWO STRIPPED CABLE ENDS THROUGH THE TWO HOLES IN THE BACK OF THE SCREW TERMINAL END

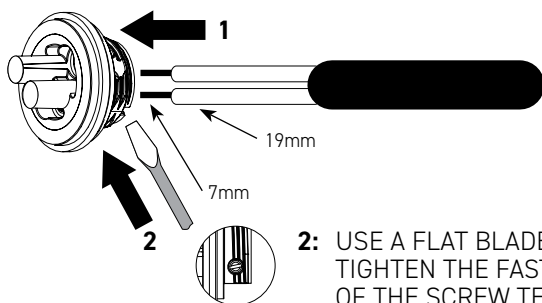

- 2: USE A FLAT BLADE SCREWDRIVER TO TIGHTEN THE FASTENERS ON EITHER SIDE OF THE SCREW TERMINAL

9B

CONNECT THE SCREW TERMINAL END

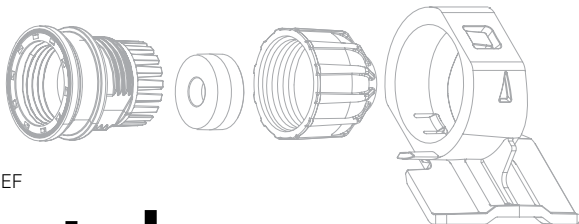
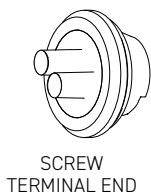

1: ATTACH THE STRAIN RELIEF CLIP TO THE SCREW TERMINAL END

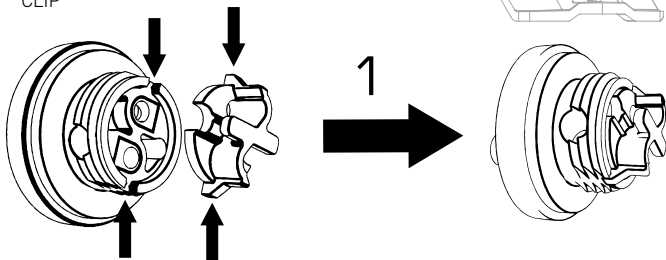

2: FEED THE TWO STRIPPED CABLE ENDS THROUGH THE TWO HOLES IN THE BACK OF THE SCREW TERMINAL END

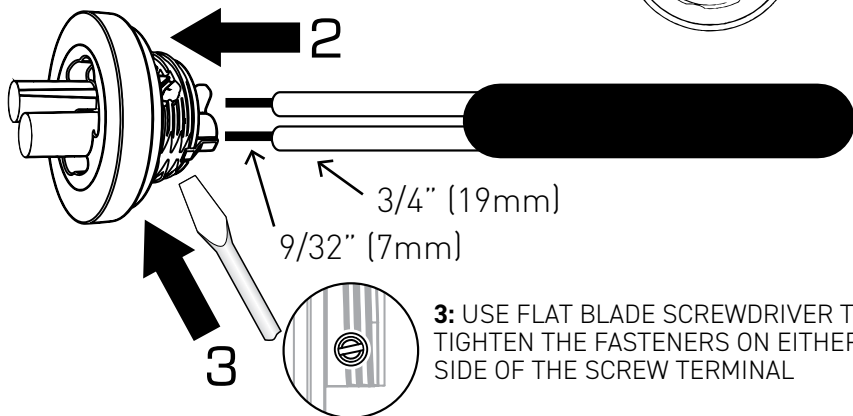

4: TWIST THE SCREW TERMINAL AND LOOP CABLE ENDS UNDER THE STRAIN RELIEF CLIP

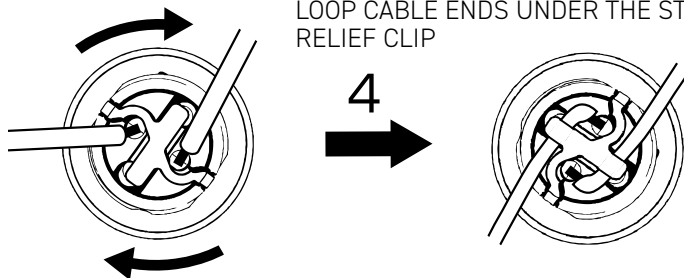

10

START ASSEMBLY OF CONNECTOR PLUG

CAREFULLY THREAD CONNECTOR BARREL ONTO SCREW TERMINAL AND TIGHTEN FIRMLY BY HAND

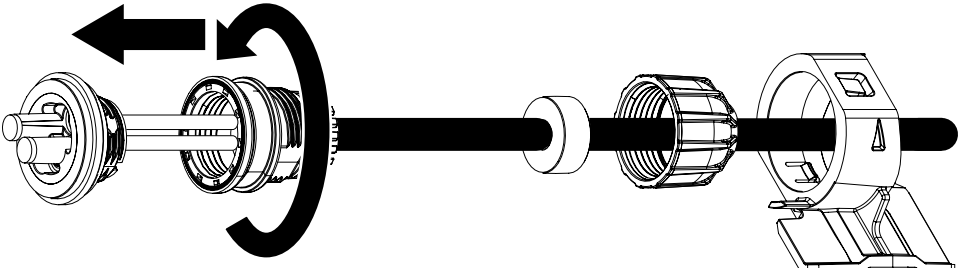

LEAVE THESE PARTS DISASSEMBLED UNTIL AFTER ADDING LANOLIN

11

ADD LANOLIN

LANOLIN USE



GENTLY WARM
LANOLIN
BEFORE USE

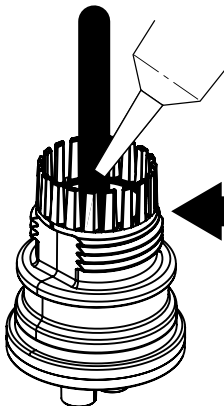

FILL BACK OF CONNECTOR BARREL WITH LANOLIN UP TO THE INDICATED POINT

FILL TO HERE
(ALLOWING ROOM FOR GLAND)

12

CONTINUE ASSEMBLY OF CONNECTOR PLUG

1: SEAT CABLE GLAND ALL THE WAY INTO CONNECTOR (DO A VISUAL CHECK TO MAKE SURE THERE IS A SEAL BETWEEN THE GLAND AND CABLE)

2: CAREFULLY THREAD GLAND NUT ONTO CONNECTOR BARREL

3: TIGHTEN GLAND NUT FIRMLY BY HAND

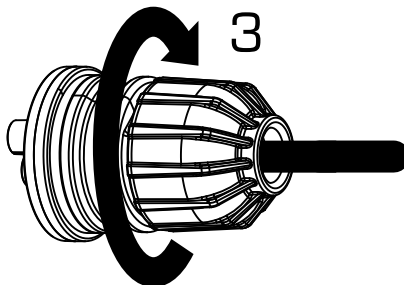
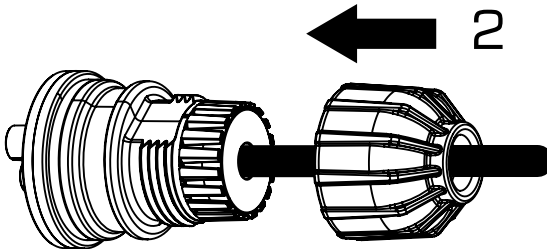
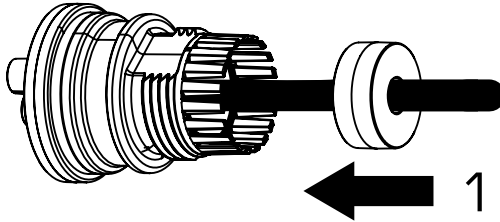

13

CONTINUE ASSEMBLY OF CONNECTOR PLUG

- 1: DO A PULL TEST ON THE PLUG ASSEMBLY SO FAR, ALL ASSEMBLED PARTS SHOULD FEEL FIRM AND TIGHT
- 2: PUSH CONNECTOR COLLAR ALL THE WAY IN TO THE END UNTIL THERE ARE TWO DISTINCT "CLICKS". THE END WILL BE FREE TO ROTATE

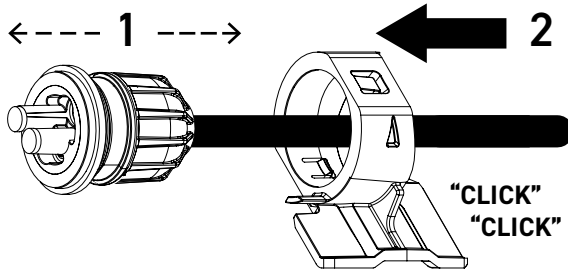

ASSEMBLED VIEW OF CONNECTOR PLUG

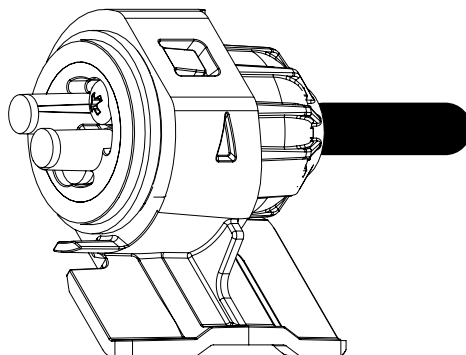

B: ATTACH ADAPTOR PLATE

OVERVIEW OF ADAPTOR PLATE INSTALL

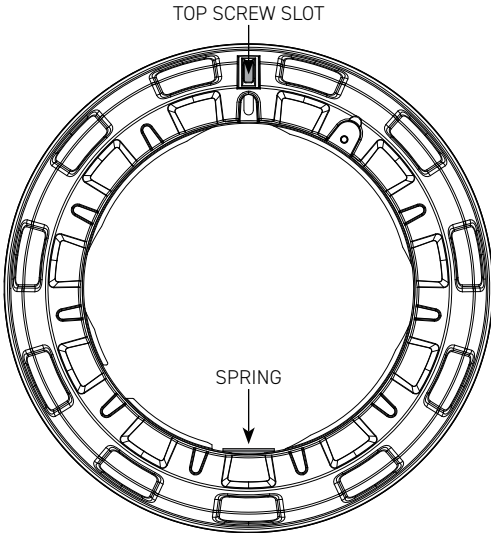

FRONT VIEW

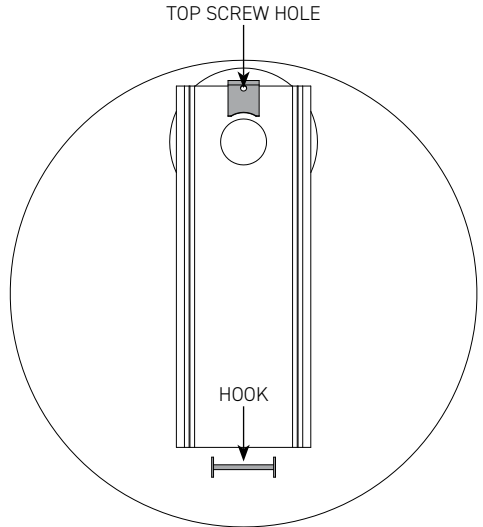

EXISTING AQUALUMIN MOUNTING PLATE

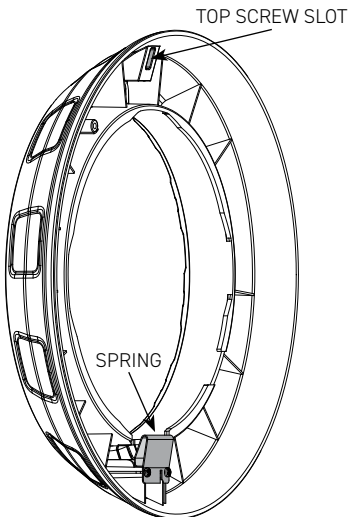

REAR ANGLE VIEW

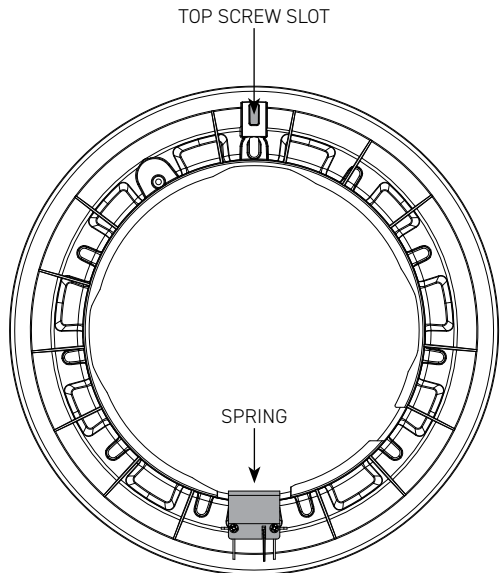

REAR VIEW

OVERVIEW OF ADAPTOR PLATE INSTALL ...CONTINUED

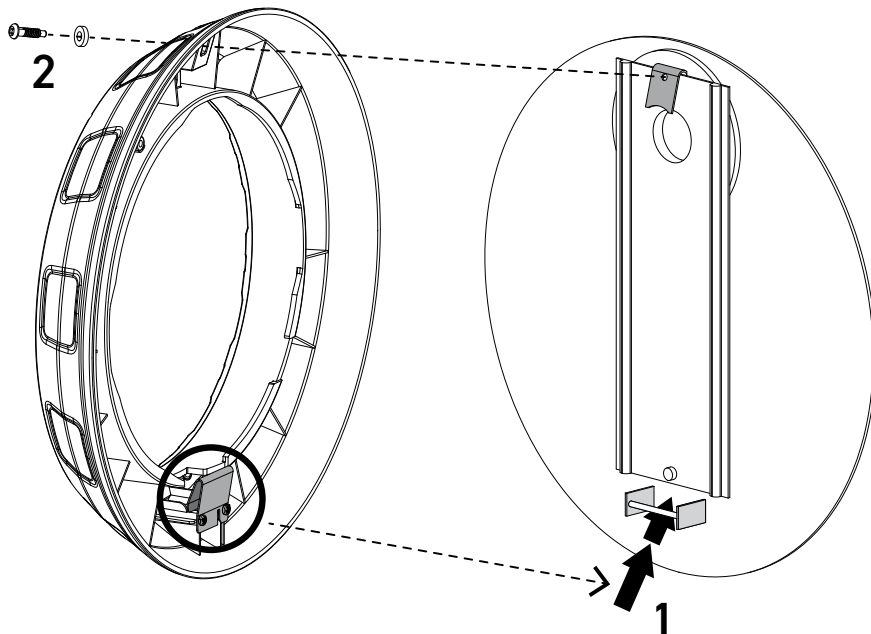

1 FEED THE CABLE

FEED THE CABLE THROUGH THE ADAPTOR PLATE

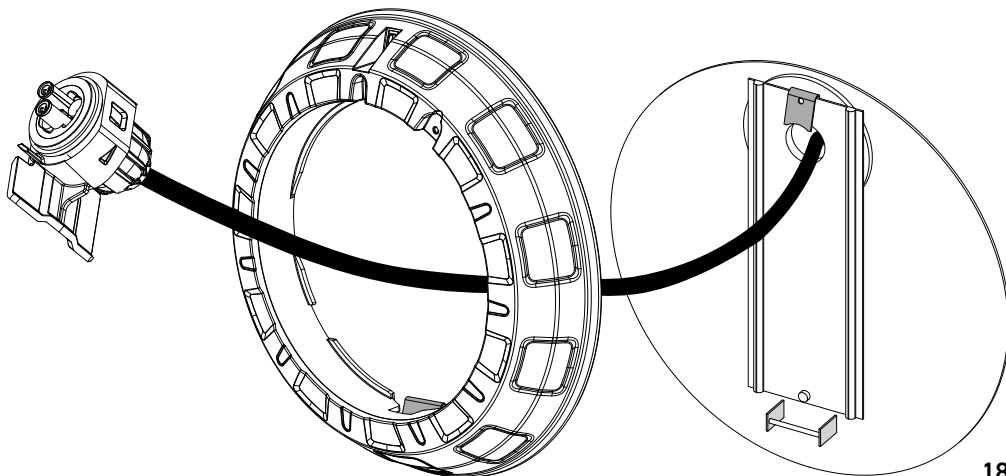

2

ATTACH ADAPTOR PLATE

1. PLACE THE ADAPTOR OVER THE MOUNTING PLATE, POSITIONED SO THE **SPRING** IS UNDERNEATH THE **HOOK**.

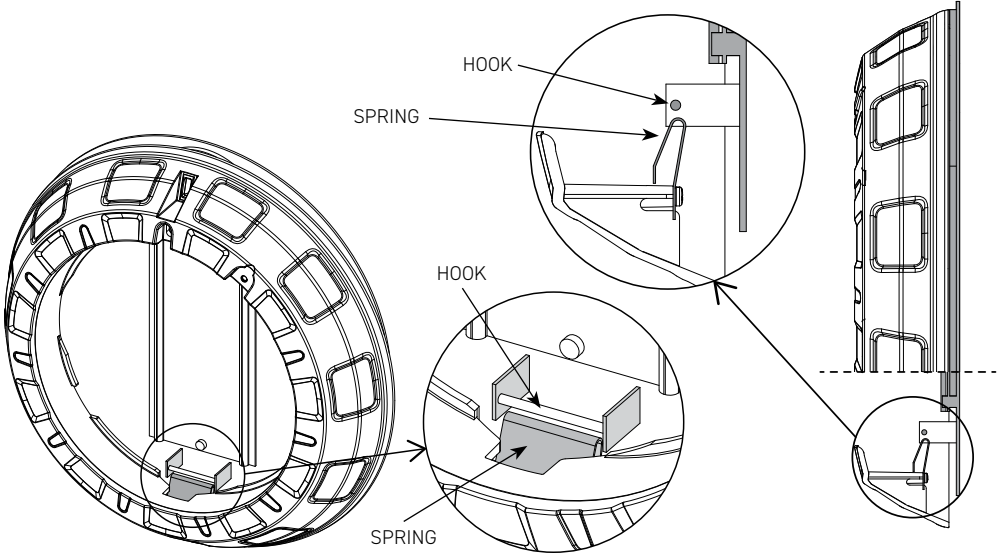

2. SLIDE THE ADAPTOR PLATE UP SO THE **SPRING** SLOTS IN BEHIND THE **HOOK**. NOTE: ONLY SLIDE THE ADAPTOR PLATE UP ENOUGH SO THAT THE TOP SCREW HOLE ON THE EXISTING MOUNTING PLATE IS ALIGNED WITH THE SLOT ON THE ADAPTOR PLATE.

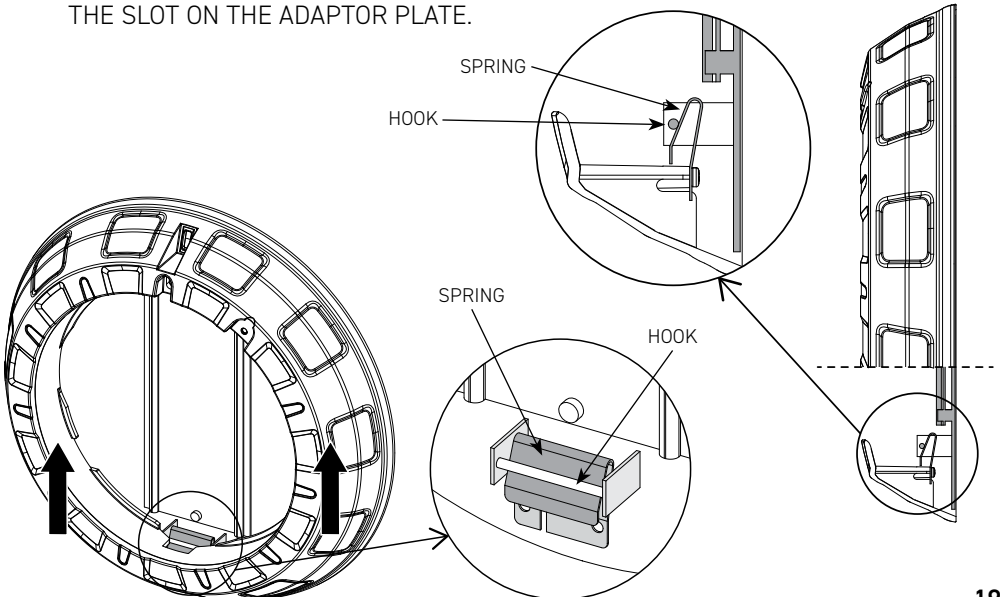

3

ATTACH TOP SCREW

USE A PHILLIPS HEAD SCREWDRIVER TO THREAD THE MOUNTING SCREW AND WASHER THROUGH THE ADAPTOR PLATE INTO THE EXISTING MOUNTING PLATE TOP SCREW HOLE.

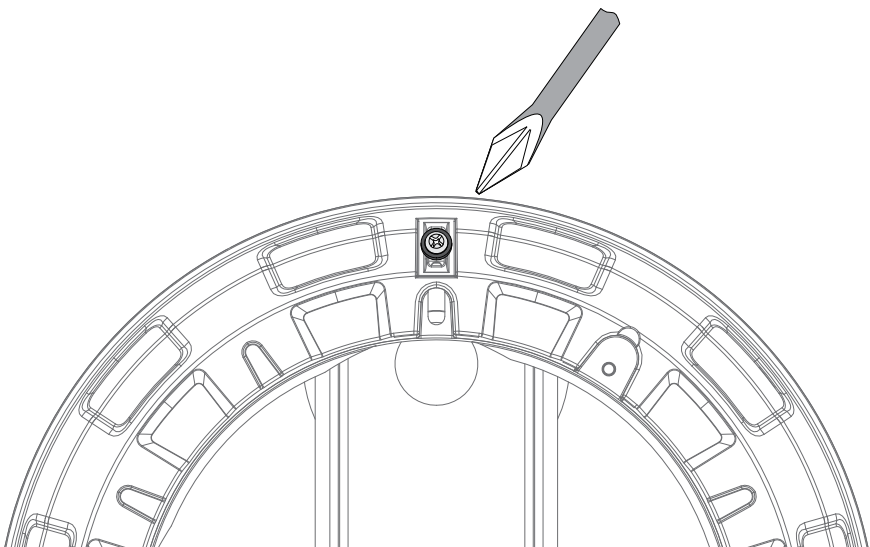
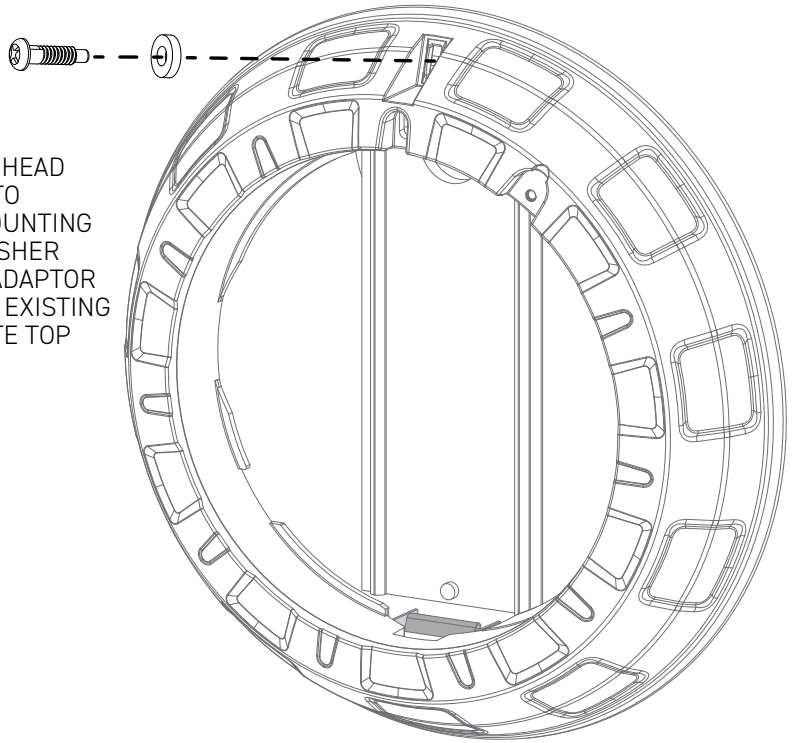

C: CONNECT LUMINAIRE

1 ALIGN UP AND CONNECT CONNECTOR PLUG

1: TURN THE LUMINAIRE OVER TO SEE THE BACK

2: LOCATE THE CONNECTOR SOCKET

3: LINE UP THE TERMINALS OF THE SOCKET WITH THE CONNECTOR PLUG

4: SLIDE THE CONNECTOR PLUG FIRMLY INTO THE SOCKET WITH THE LEVER HORIZONTAL

5: FOLD THE LEVER UPRIGHT UNTIL IT LOCKS INTO PLACE VERTICALLY

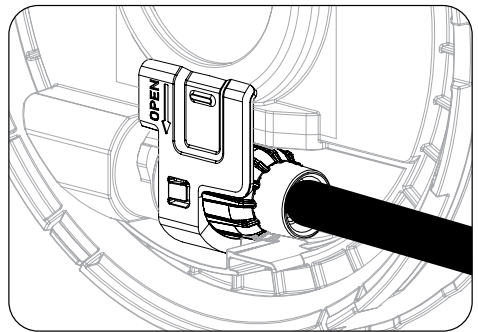
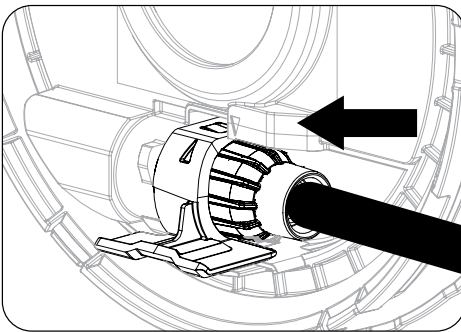
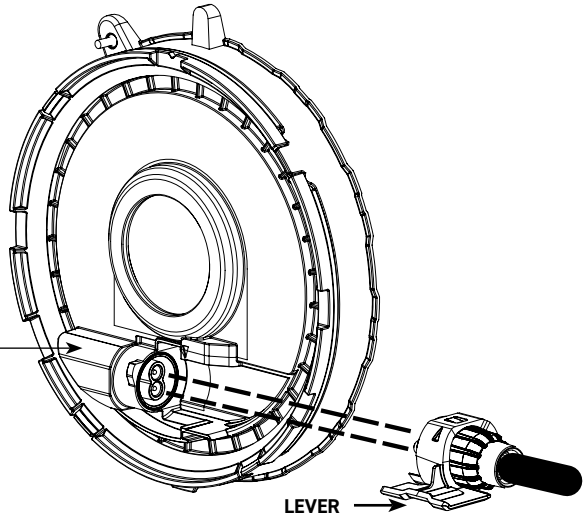

D: FIT LIGHT TO ADAPTOR PLATE

1 COIL EXCESS CABLE INTO BACK OF ADAPTOR

COIL THE EXCESS CABLE INTO BACK OF THE ADAPTOR PLATE ANTI-CLOCKWISE.

ENSURE THE CABLE DOES NOT OVERLAP.

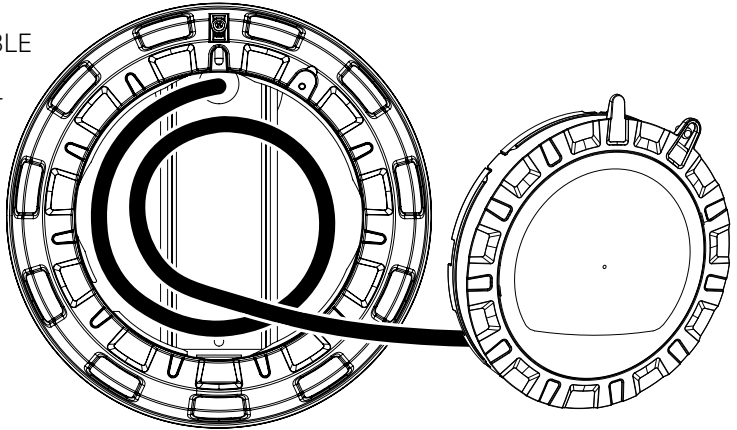

IF YOU ARE HAVING ANY DIFFICULTIES IN FITTING THE CABLE AND LIGHT ASSEMBLY INTO THE ADAPTOR, TRY THE FOLLOWING:

1. TUCK THE CABLE IN BEHIND THE ADAPTOR PLATE.
2. CHECK THE CABLE IS CLEAR OF THIS RAISED AREA ON THE BACK OF THE LIGHT ASSEMBLY.
3. ENSURE THE COILED CABLE DOES NOT OVERLAP ON ITSELF WHEN INSERTING THE LIGHT ASSEMBLY. OVERLAPPING CABLE CAN CAUSE THE LIGHT TO SIT PROUD OF THE ADAPTOR PLATE.
4. ADJUST THE LENGTH OF THE CABLE TO THE RECOMMENDED MEASUREMENT AS PER INSTALLATION SECTION A, STEP 3.

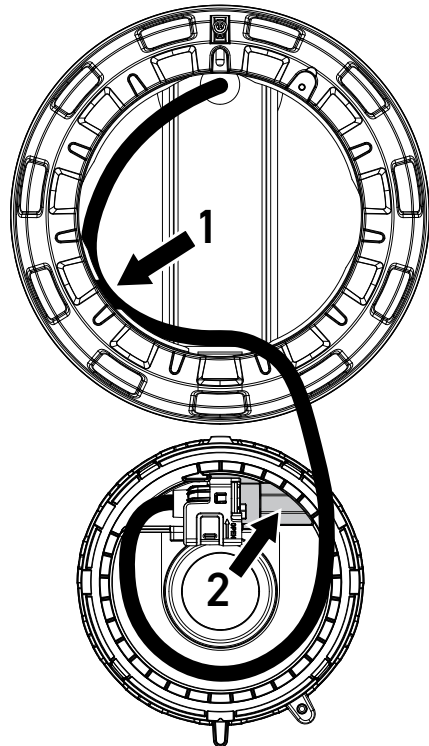

2

CONNECT LIGHT ASSEMBLY

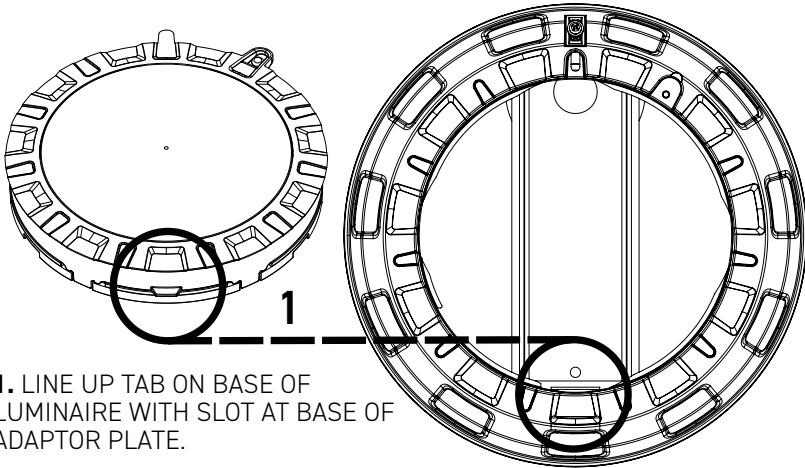

1. LINE UP TAB ON BASE OF LUMINAIRE WITH SLOT AT BASE OF ADAPTOR PLATE.

2. INSERT THE BASE TAB OF THE LUMINAIRE INTO THE ADAPTOR PLATE.

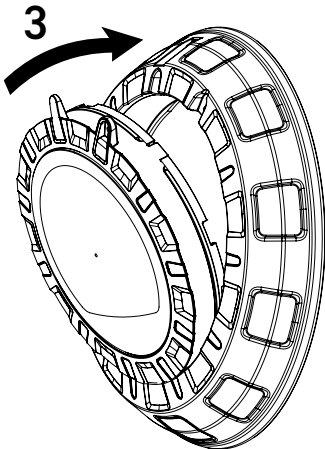
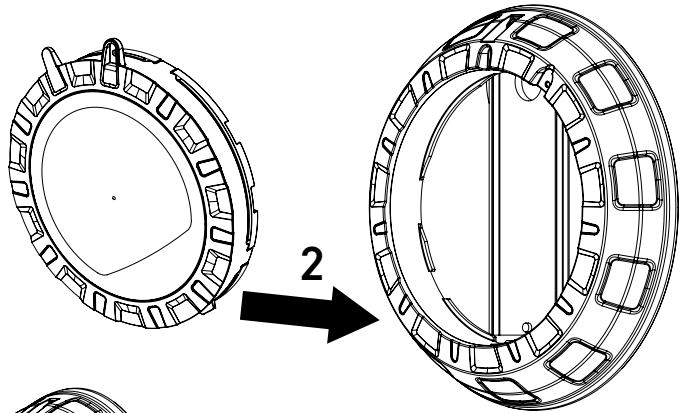

3. THEN PUSH THE TOP PART OF THE LUMINAIRE INTO THE ADAPTOR PLATE.

2

CONNECT LIGHT ASSEMBLY ...CONTINUED

4. PUSH LUMINAIRE INTO PLACE ENSURING TAB LOCATES AT TOP AT 12 O'CLOCK

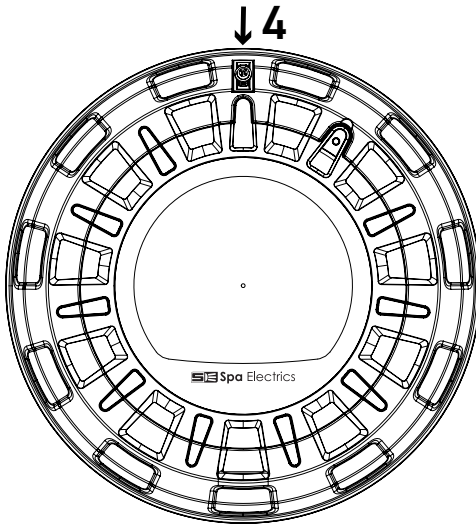

5. USE A SCREWDRIVER TO TIGHTEN THE LIGHT MOUNTING SCREW.

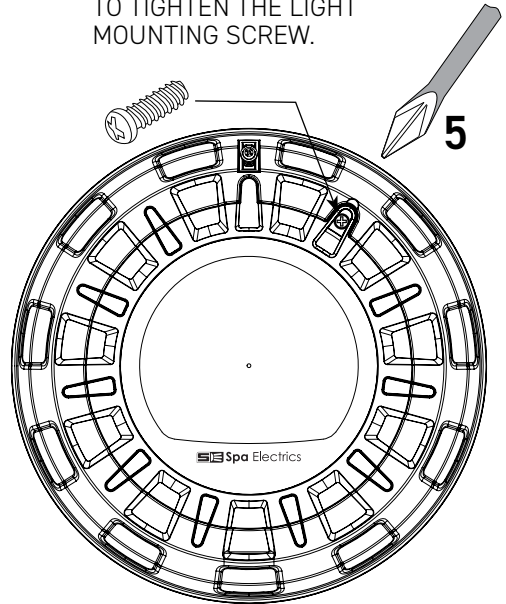

POST INSTALLATION CHECK

1

TEST SYSTEM

TURN ON POWER AND CHECK ALL WORKING CORRECTLY

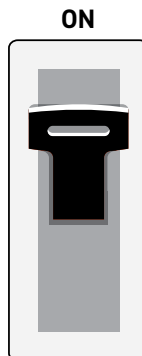

TURN ON BREAKER TO POOL LIGHT TRANSFORMER

WINTERIZATION

1 DETACH THE LIGHT ASSEMBLY

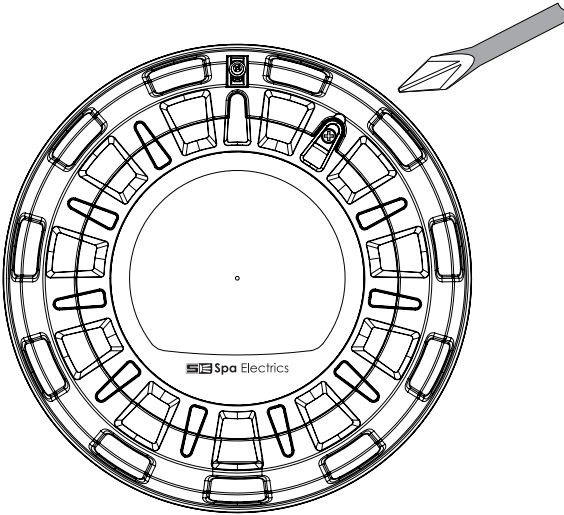

USE A SCREWDRIVER TO LOOSEN THE SCREW

2 PULL OUT LIGHT ASSEMBLY

PULL THE LIGHT ASSEMBLY FORWARD AND UP SO IT LIFTS OFF THE TAB AT BASE

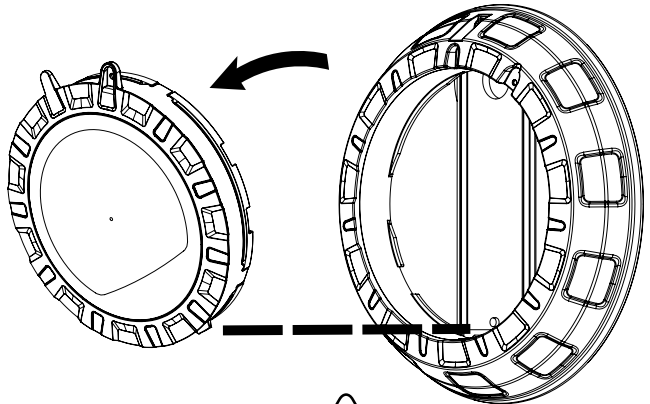

NOTE



BRING ABOVE WATER LINE BEFORE DETACHING CABLE

3

UNLOCK THE PLUG

FOLD THE LEVER DOWN SO THE LEVER IS HORIZONTAL

THE LIGHT ASSEMBLY IS NOW READY TO BE REMOVED

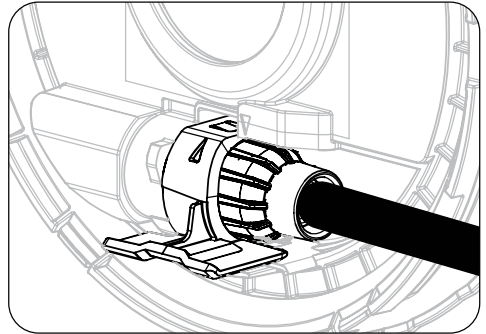
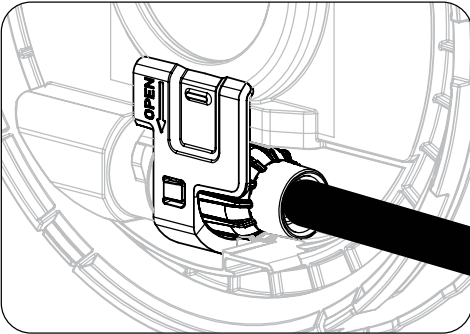

3

REMOVE THE LIGHT ASSEMBLY

PULL OFF THE LIGHT ASSEMBLY

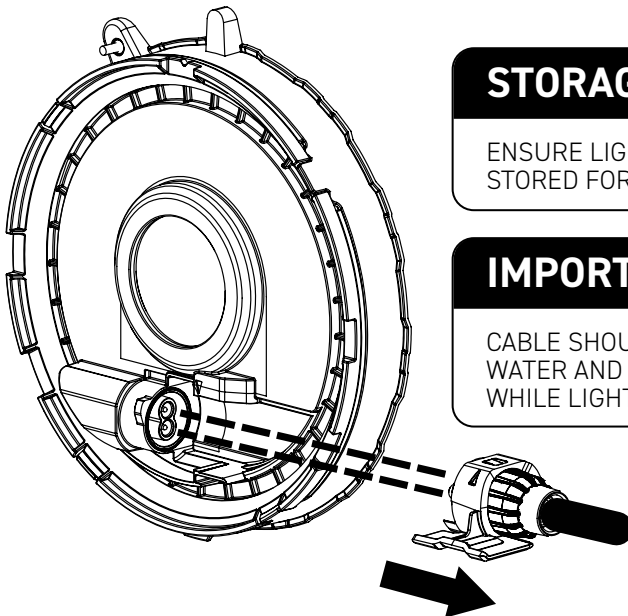

STORAGE



ENSURE LIGHT ASSEMBLY IS SAFELY STORED FOR NEXT SEASON USE

IMPORTANT NOTE



CABLE SHOULD BE SECURED ABOVE WATER AND WEATHER PROTECTED WHILE LIGHT IS DETACHED

5

CONNECT WINTERIZATION PLUG CAP

LINE UP THE WINTERIZATION PLUG CAP TO THE PLUG

SLIDE INTO PLACE UNTIL SECURE

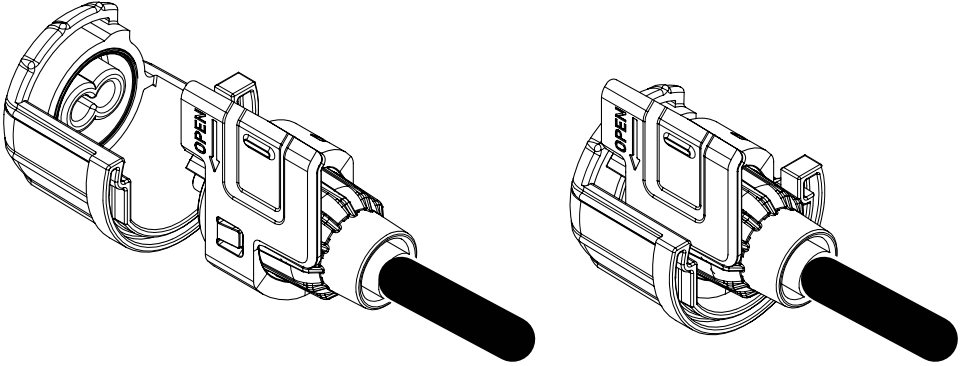

6

LOCK ON WINTERIZATION PLUG CAP

FOLD DOWN THE LEVER TO LOCK IN PLACE

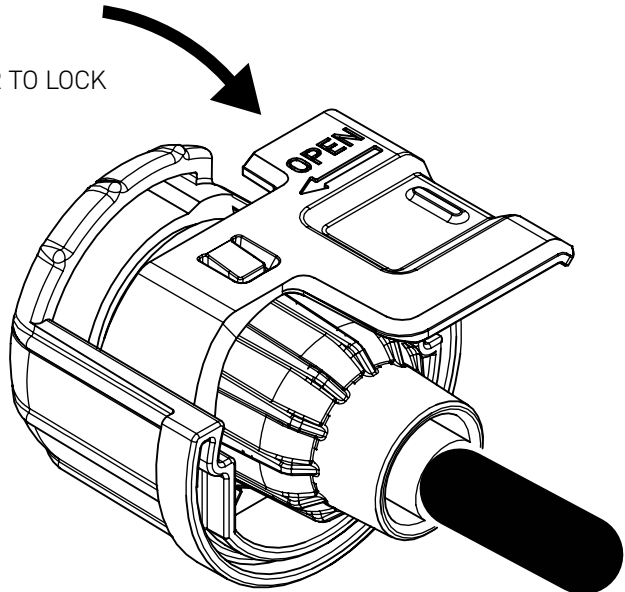

TROUBLESHOOTING

ISSUE	REASON	ACTION
Light returns to WHITE colour during manual colour change.	Light synchronization process has been triggered.	Refer to MultiPlus User Guide instructions.
Light flashes red	Light over heating	Check light is fully submerged. Check vents are not obstructed
Light not operating (1)	Faulty connection to transformer	Ensure cable correctly connected to transformer terminals
Light not operating (2)	Mains power not connected	Check transformer is plugged in to GPO and switched on
Light not operating (3)	Damaged cable	Disconnect plug top and test voltage under load using multi-meter (ie. 50w 12v) Required voltage (11v ~ 13.5v)
Light not operating (4)	Transformer not working	Check fuses & test transformer using multimeter under load (ie.50w 12v)
Light colours not synchronized with controller	Incorrect operating mode selected.	Refer to MULTI PLUS setup procedure

If these issues cannot be resolved with the above recommended actions, please contact your local Spa Electrics reseller or Spa Electrics directly.

ELECTRICAL GROUNDING

Underwriters Laboratories (UL) Statement

Per the NEC, NFPA 70, Article 680.23 (B)(5), states that bonding shall not be required for luminaires that are listed for the application and have no non-current carrying metal parts. In addition, per Article 680.26 (B)(4), exception states that Listed low-voltage lighting systems with non-metallic forming shells shall not require bonding.

Therefore, luminaires with polymeric/non-current carrying metal parts are not required to be grounded / bonded.

Manufacturers Statement

Spa Electrics **Retro Universal** luminaires with their plastic housing designs do not require grounding / bonding.

Spa Electrics **Retro Universal** lights have also been determined to comply with the applicable requirements for wet-niche, LED type Swimming Pool and Spa Luminaires.

FCC COMPLIANCE STATEMENT

This device complies with part 15 of the FCC rules. Operation is subject to the following two (2) conditions:

- (1) This device may not cause harmful interference, and
- (2) this device must accept any interference received, including interference that may cause undesired operation.

Note: This equipment has been tested and found to comply with the limits for a Class B digital device, pursuant to part 15 of the FCC Rules. These limits are designed to provide reasonable protection against harmful interference in a residential installation. This equipment generates, uses and can radiate radio frequency energy and, if not installed and used in accordance with the instructions, may cause harmful interference to radio communications. However, there is no guarantee that interference will not occur in a particular installation. If this equipment does cause harmful interference to radio or television reception, which can be determined by turning the equipment off and on, the user is encouraged to try to correct the interference by one or more of the following measures:

- **Reorient or relocate the receiving antenna.**
- **Increase the separation between the equipment and receiver.**
- **Connect the equipment into an outlet on a circuit different to that to which the receiver is connected.**
- **Consult the dealer or an experienced radio / TV technician for help.**

Do not make any changes or modifications to the equipment unless otherwise specified in the manual.

KEY DIMENSIONS

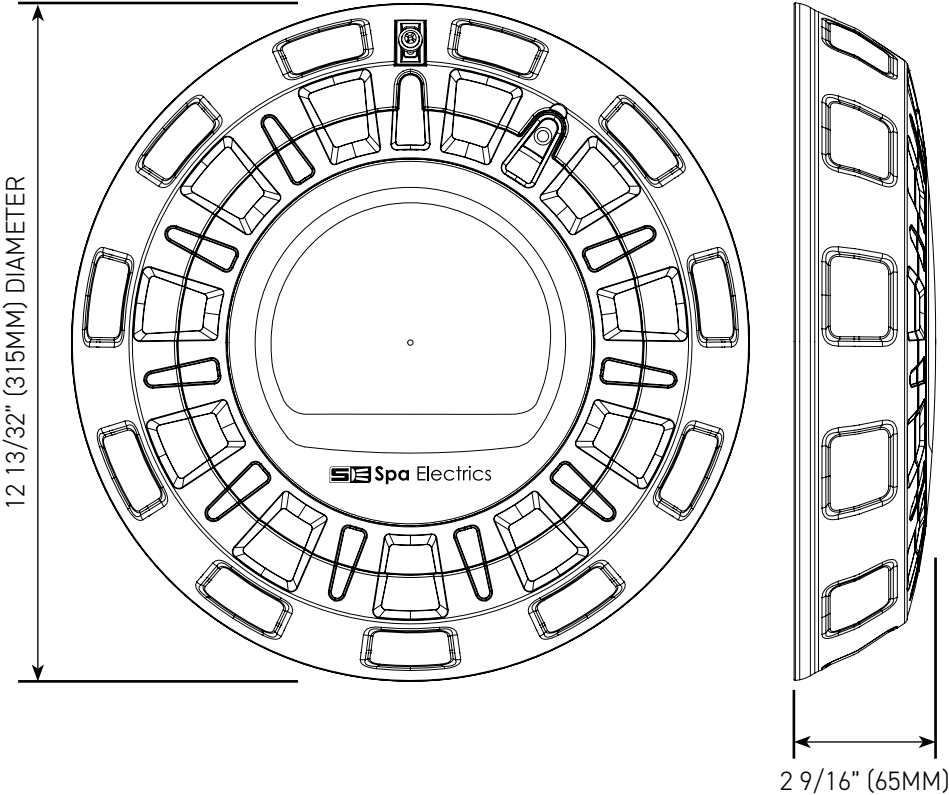



IMPORTANT NOTE

PLEASE STORE THIS MANUAL IN A SAFE PLACE
FOR FUTURE REFERENCE



 **Spa Electrics[®]**

The underwater lighting specialists

spaelectrics.com

©COPYRIGHT 2025 SPA ELECTRICS INC.
ALL RIGHTS RESERVED

US 2025 09 25